



## Need More Space? Huge Industrial Building with **PRICE** By Negotiation

A brand new high spec industrial building to be constructed on a high profile corner site of 3,834m<sup>2</sup> in the thriving Te Rapa gateway industrial development providing easy access to the Waikato Expressway and other major arterial routes. Long leases available so If your current premises is bursting at the seams or your looking for something to grow into this building is your future. Featuring 1,698m<sup>2</sup> of Warehousing 350m<sup>2</sup> Office 281m<sup>2</sup> Canopy 20 Carparks Call Paul Knox on 021 669 010 to discuss your requirements.

**VIEW** By appointment  
**WEB** [www.eves.co.nz/ehvc087r](http://www.eves.co.nz/ehvc087r)



**Paul Knox**

**M** 021 669 010

**B** 07 903 8039

**E** [paul.knox@eves.co.nz](mailto:paul.knox@eves.co.nz)

**Web** [paulknox.eves.co.nz](http://paulknox.eves.co.nz)

## Property Information Memorandum



**Property Address:** Lot 21 Cnr Chalmers and Clem Newby Road, Te Rapa

**Legal Description:**

**Land Area:** 3,834 square metres (approx)

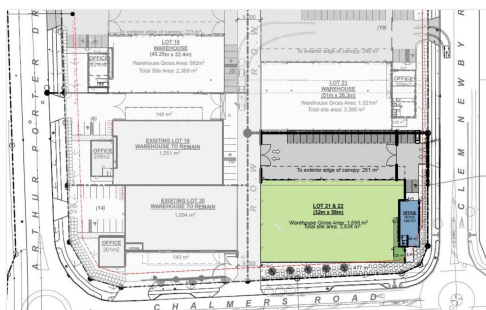
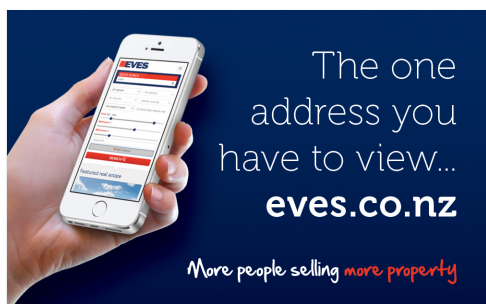

Image to follow



Image to follow



\*Please note: the floor area and property information was sourced from Property Guru and/or LINZ.

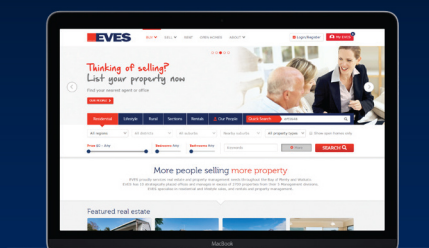

The one address  
you have to view.

Visit **eves.co.nz**

More people selling **more property**

## LOOKING FOR A HOME LOAN?

Talk to the team at Lifetime. Our mortgage Advisers are qualified, experienced and committed to providing a friendly service to assist you along your journey.

### For all your lending needs:

- + First home buyers
- + Construction Loans
- + Top-ups
- + Investors
- + Refinances
- + Re-fixes

**0800 656 466 | lifetime.co.nz**

Level 1, ANZ Building,  
247 Cameron Road, Tauranga

**Lifetime**  
Advice For Life

